

SERIES DIF



■ Applications

Daspass inline fan is useful for supply and exhaust ventilation systems for various premises suitable for external surface mounting or behind false ceiling.

■ Design

The fan casing is made of galvanised steel.

■ Motor

- The impeller with backward blades is powered by the single phase motor with external rotor and overheating protection with automatic restart. The motor is equipped with ball bearings for long service life designed for at least 40000 hours. For precise features, safe operation and low noise, each impeller is dynamically balanced while assembly. Motor protection rating IP 44 & Class F Insulation.



SOURCE OF ENERGY

Speed control

Both smooth and step speed control is performed with the thyristor or auto transformer controller. Several fans can be connected to one controller in case the total power and operating current do not exceed the rated controller values.

■ Mounting

Mounting at any angle to wall or ceiling is performed with fastening brackets supplied with the unit. The fan is powered by means of the external terminal box. Electric connection and mounting shall be performed in compliance with the manual and wiring diagram on the terminal box.

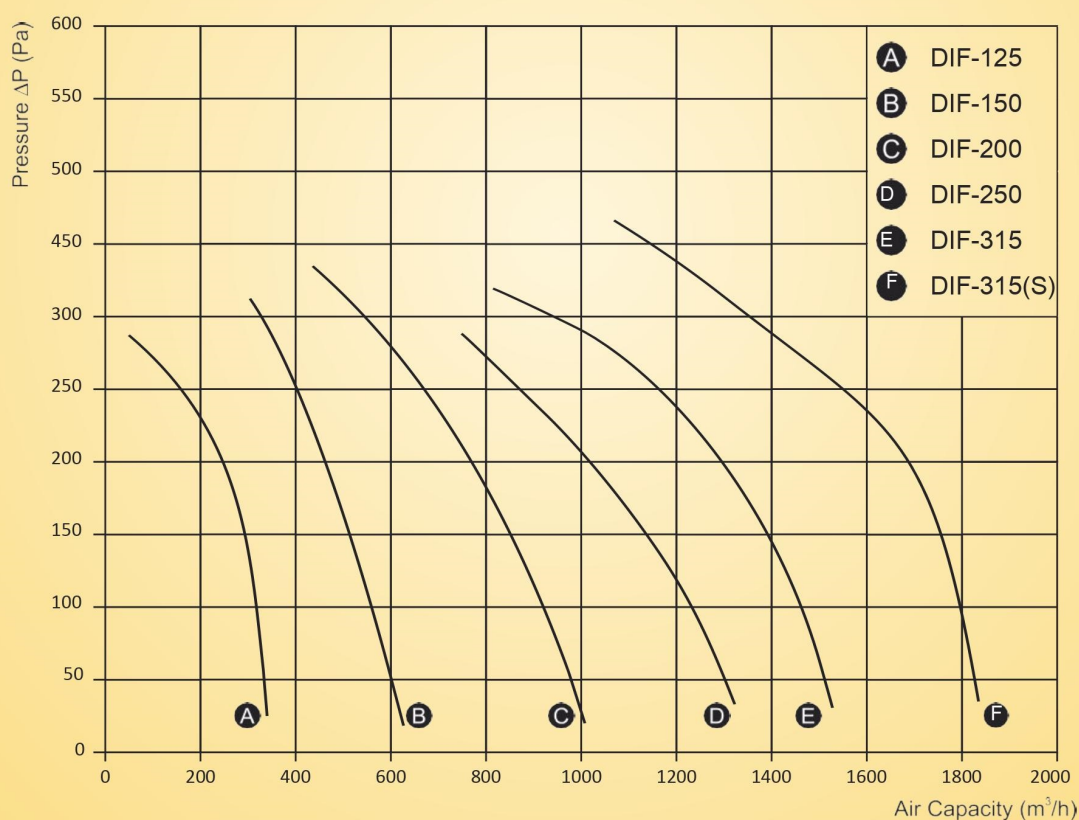

External terminal box for power supply

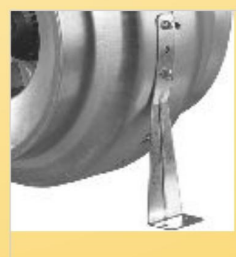

Fastening bracket for easy mounting supplied with the fan

	DIF 125	DIF 150	DIF 200	DIF 250	DIF 315	DIF 315 (S)
Voltage (V/50 Hz)	230	230	230	230	230	230
Power (W)	80	150	150	200	250	290
Current (A)	0.38	0.65	0.7	0.9	1.1	1.34
RPM [min ⁻¹]	2500	2580	2580	2550	2500	2600
Noise level at 3m [dBA]	45	46	48	51	52	53
Maximum Operating temperature [°C]	-25+55	-25+55	-25+55	-25+50	-25+45	-25+45
Protection Rating	IP x 4	IP x 4	IP x 4	IP x 4	IP x 4	IP x 4
Insulation Class	F	F	F	F	F	F

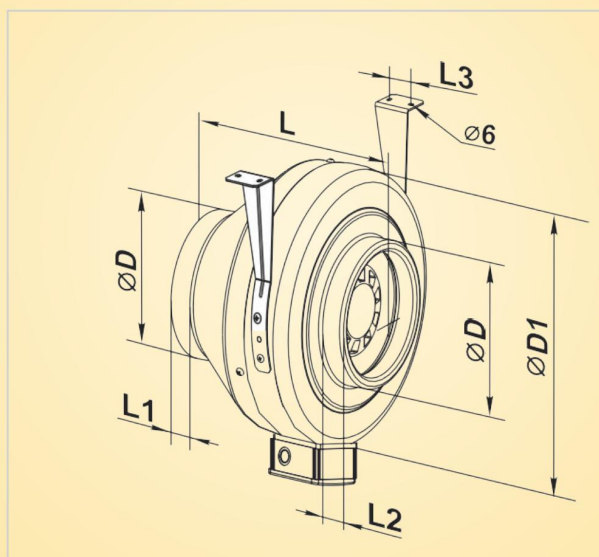

Fan overall dimension

TYPE	Dimension [mm]						Weight [kg]
	ØD	ØD1	L	L1	L2	L3	
DIF 125	123	247	193	26	26	30	3.5
DIF 150	148	336	235	25	25	30	5.3
DIF 200	198	336	228	26	26	40	5.3
DIF 250	248	336	213	25	32	40	5.9
DIF 315	313	403	256	26	26	40	7.3
DIF 315 (S)	313	403	256	26	26	40	7.8

Daspass Appliances

Regd. Off.: 29/19, Gali No. 6 Anand Parvat industrial area New Delhi -11005

Tel.: 011-43596452, +91 9891023817

Email : daspasappliances@gmail.com



■ **Daspass Appliances** CabinetBox Fans (Series DCIF) features a unique combination of Rugged Construction, High Efficiency and Low Sound Level & Ease of Service. The construction of Fan allows it to be mounted in any configuration - Horizontal or Vertical.

■ **DCIF** Box Fans are ideal selection for indoor clean air application for Exhaust, Supply or Make-up Air System. The compact Design enables installation in tight spaces & are suitable to handle air upto 50°C

■ **CABINET**

• The Fan housing is constructed of Rigid Structural members & formed GSS Panels in 275 GSM Zinc Coating.

■ **IMPELLERS**

• Fans are provided with Aluminium construction Backward Inclined, Non-Overloading, Statically & Dynamically balanced Centrifugal Wheels to deliver maximum efficiency.

■ **DUCT COLLAR**

• Large Size Duct Collars are provided for reduced outlet velocity hence quieter operation.

■ **MOTOR**

• Permanently lubricated, sealed Ball Bearing motors are selected to provide trouble free operation with minimum maintenance. Motors have IP-44 Protection with Class-B insulation. 100% Factory Tested Bearings are designed for Air Handling application with life in excess of 1,00,000 hours.

■ **MOTOR FARMER**

• Constructed of heavy gauge galvanised steel for sturdy support.

■ **ACCESS PANEL**

• The Cabinet construction have access panel on two sides to permit easy access to all internal components.

■ **OPTIONAL**

• The unit comes with optional features as
» 25 mm Thick Pre-Filter for Fresh Air Application
» Internal Acoustic Insulation of Panels.

Technical Data

Model	Speed (RPM)	Power (W)	Current (AMP)	NOISE LEVEL AT 3M (DBA)	Weight (kg)
DCIF -14	1450	300	2.5	53	29
DCIF -18	1450	300	2.5	55	32
DCIF -25	1450	500	4.8	60	41
DCIF -33	1450	900	7.5	63	45

Note : All Fans are suitable for 200V, 50Hz, Single Phase Power Supply

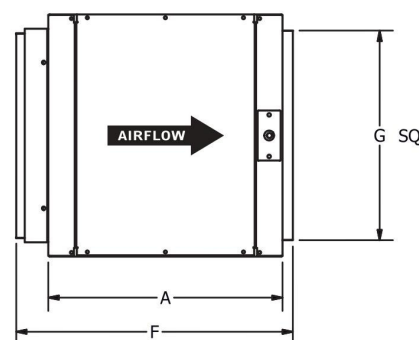
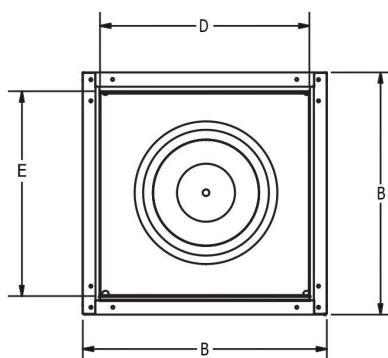
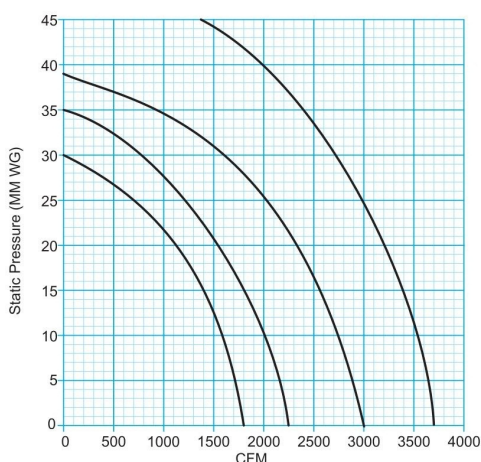

Model	A	B	D	E	F	G
DCIF -14	535	481	400	390	635	404
DCIF -18	538	530	450	442	640	452
DCIF -25	561	582	500	492	664	503
DCIF -33	657	657	578	568	762	580

Daspass Appliances

Regd. Add. 29/19 Gali No. 6 Anand Parvat Industrial Area New Delhi -110005 (India)

Tel.: +0091-11-43596452, 9891023817, Email : millenniumhouse98@gmail.com, daspassappliances@gmail.com

■ Applications

"Daspass Appliances" DMFI fans are featured with wide capabilities and high performance of axial and centrifugal fans and are specifically designed for supply and exhaust ventilation of premises requiring high pressure, powerful air flow and low noise level.

■ Design

The fan casing is made of high quality and durable low-flammable polypropylene.

The removable impeller and motor block with a terminal box is fixed to the casing assembled with the spigots by means of special clamps with latches. This makes the fan maintenance fast and easy. The fan maintenance does not require total disassembling. Just pull out the central block from the casing and perform required servicing.

■ Design features:

The inlet spigot is equipped with a collector to enable smooth air inlet to the fan. The hemispheric impeller shape and specially profiled blades increase the air flow circular velocity and provide higher pressure and capacity as compared to standard axial fans.

■ Motor

The models of DMFI series are equipped with a single-phase motor. The motors have thermal overheating protection to prevent the motor overload. The ball bearings extend the motor service life up to 40,000 hrs. at non-stop operation. The motor has IP X4 ingress protection & Class B Insulation.



SERIES-DMFI



Performance Curve

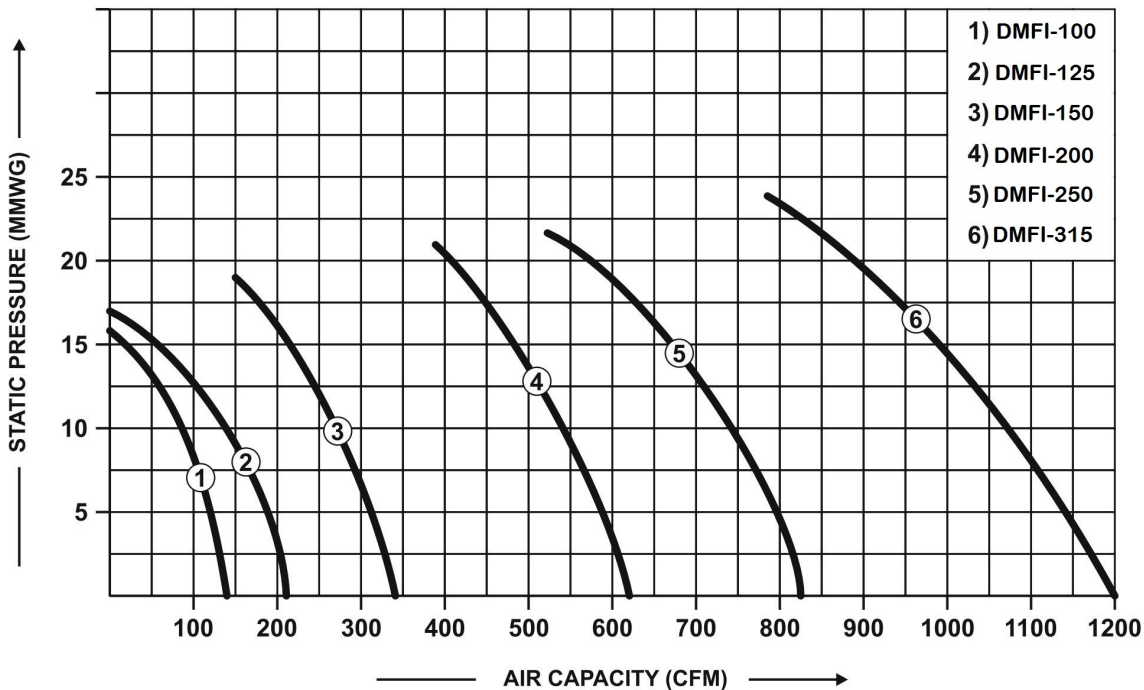

Daspass Appliances

Regd. Add. 29/19 Gali No. 6 Anand Parvat Industrial Area New Delhi -110005 (India)

Tel.: +0091-11-43596452, 9891023817, Email : millenniumhouse98@gmail.com, daspassappliances@gmail.com

Technical Data

Model No.	Power (W)	Current (Amps)	Speed (RPM)	Noise (db)	Net Weight (kgs)
DMFI-100	26	0.12	2200	31	1.5
DMFI-125	33	0.14	2250	32	1.5
DMFI-150	54	0.22	2550	33	2.6
DMFI-200	128	0.53	2450	49	4.9
DMFI-250	225	1.20	2450	52	7.5
DMFI-315	390	1.90	2350	53	11.0

Note:

- 1) All Fans are suitable for 220V, 50Hz Single Phase power supply.
- 2) All Fan Motors have Class-B insulation.

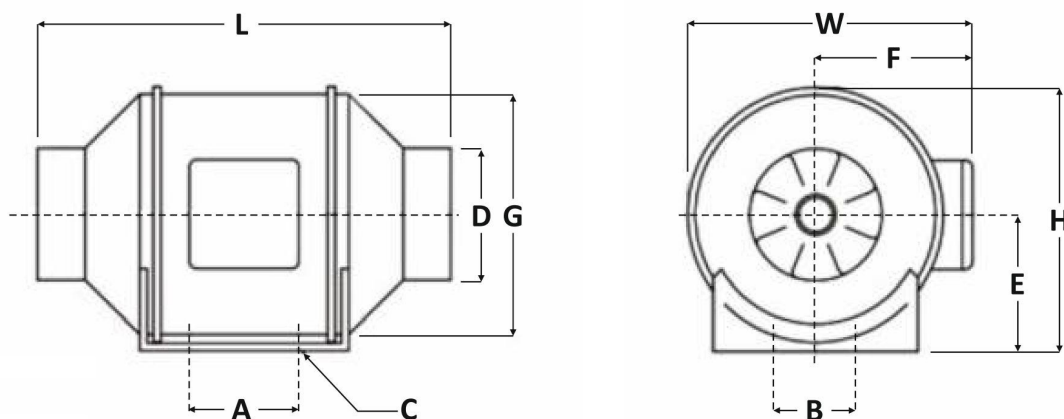

Model	A	B	C	ØD	E	F	ØG	L	W	H
DMFI-100	80	60	Ø4.5	97	99	116	163	302	204	195
DMFI-125	80	60	Ø4.5	123	99	116	163	257	204	195
DMFI-150	80	60	Ø5.0	147	109	127	187	313	227	208
DMFI-200	100	94	Ø5.5	197	125	137	205	302	249	237
DMFI-250	150	150	Ø8*11	247	150	174	261	383	310	286
DMFI-315	181	178	Ø8*11	312	187	216	325	446	386	357

Daspass Appliances

Regd. Add. 29/19 Gali No. 6 Anand Parvat Industrial Area New Delhi -110005 (India)

Tel.: +0091-11-43596452, 9891023817, Email : millenniumhouse98@gmail.com,



Millennium

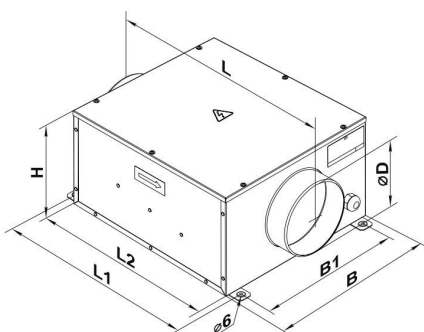

■ Applications

DSIF fan design enables its application in supply and exhaust ventilation systems for the premises with high requirements to noise level and limited mounting space. Provision is made for installation in a premise above the suspended ceiling.

■ Design

The fan casing is made of galvanized steel sheet and provided with heat- and sound-insulating material. Round connecting pipes are fitted with rubber seals.

■ Motor

The centrifugal impeller with backward curved blades is powered by means of asynchronous motor with external rotor. The motors are equipped with built-in thermal overheating protecting with automatic restart. Motor ball bearings with selective lubricating oil ensure low-noise and maintenance-free fan operation.

■ Speed Control

Both smooth or step speed control is performed with the thyristor or autotransformer controller. The motor speed is controlled by means of power voltage decrease. Several fans can be connected to one controller in case their total power and operating current do not exceed the controller rated values.

■ Mounting

The fan shall be fixed to a building by means of supports, suspension brackets or fixation brackets. The fan can be mounted in any position with respect to the air flow direction indicated with a pointer on the fan casing. Access to the fan maintenance shall be provided.



■ Fan Overall Dimension :

Type	Dimensions (mm)							Mass [kg]
	Ø D	B	B1	H	L	L1	L2	
DSIF 150	149	352	310	212	477	410	380	6,4
DSIF 250	249	432	368	287	588	506	480	12,5
DSIF 315	314	502	438	397	648	566	540	15,5

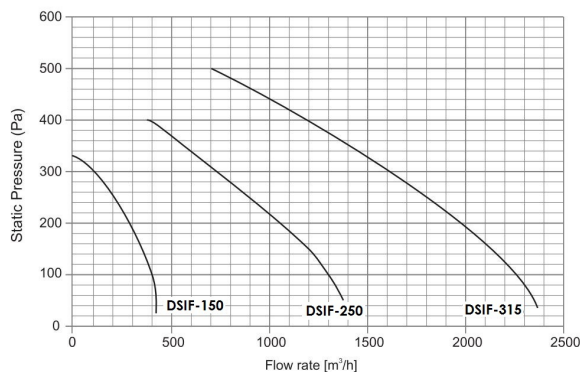

■ Technical Data :

	DSIF -150	DSIF 250	DSIF 315
Voltage [V / 50 Hz]	230	230	230
Power [W]	72	198	322
Current [A]	0,32	0,87	1,40
Maximum air flow [m³/h]	420	1300	2150
RPM [min ⁻¹]	2600	2420	2670
Noise level at 3 m [dBA]	36	41	43
Maximum Operating Temperature [°C]	-25 +55	-25 +50	-25 +45
Protection Rating	IP x 4	IP x 4	IP x 4

Daspas Appliances

Regd. Add. 29/19 Gali No. 6 Anand Parvat Industrial Area New Delhi -110005 (India)

Tel.: +0091-11-43596452, 9891023817, Email : millenniumhouse98@gmail.com, daspassappliances@gmail.com

www.mhouse.co.in

CEILING INLINE FANS

Product Information

SERIES DACIF

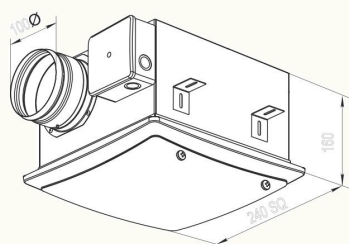
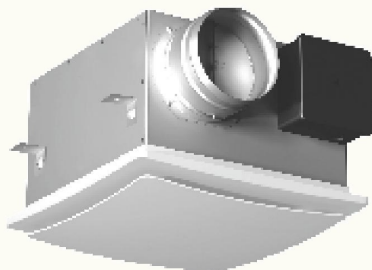

■ Application:

"Daspass appliances" Ceiling Inline Fan are used for exhaust ventilation systems in various premises with limited mounting space behind false ceiling. Designed for connection to Ø 100 mm round air ducts.

■ Design:

The fan casing is made of galvanised steel with spring loaded back draft damper to prevent back air flow. The front decorative plate is made of ABS plastic fitted with filter.

■ Motor:

Single phase external rotor motor with a centrifugal impeller. The motor is equipped with built-in overheating protection with automatic restart. The motor ball bearings ensure 40 000 hours service life. For precise features, safe operation and low noise, each impeller is dynamically balanced while assemble. Motor ingress protection rating IP 44.

■ Speed control

Speed control is performed in smooth or step mode with a thyristor or auto transformer. Several fans may be connected to one speed controller if the total fan power and current do not exceed the rated speed controller parameters.

■ Mounting:

The fan is connected to power mains through the external terminal block. Electric connections and installation operations must be in compliance with installation guidelines and wiring diagram.

Technical data:

	DACIF
Voltage V/50/60 Hz)	1-230
Power (W)	56
Current (A)	0.34
Maximum air flow [m ³ /h]	190
Rotation per minute [min ⁻¹]	2300
Noise level at 3m [dBA]	42
Maximum Operating temperature [°C]	-25 +45
Ingress Protection Rating	IP X 4
Weight	2.9 kg

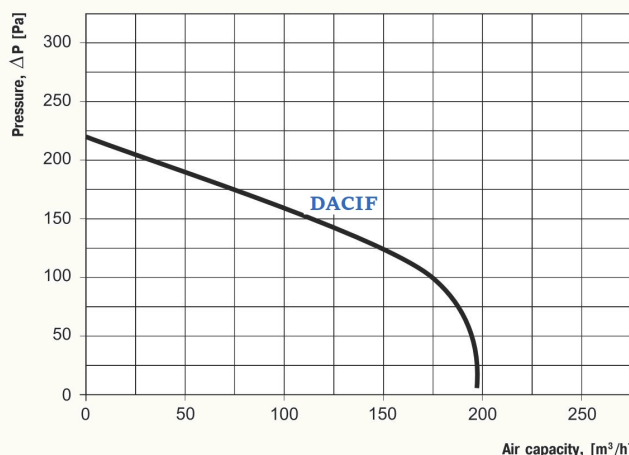

Daspass Appliances

Regd. Add. 29/19 Gali No. 6 Anand Parvat Industrial Area New Delhi -110005 (India)

Tel.: +0091-11-43596452, 9891023817, Email : millenniumhouse98@gmail.com, daspassappliances@gmail.com